



SANITARY WARE

PRODUCT CATALOGUE

INDUSTRIAL PURPOSE

CONTACT US

Telephone : +971 4 564 9817
Email : info@build-wells.com
Web : www.build-wells.com
Head Office : Dubai, UAE

lowell
SANITARY WARE



Bwell holds pride in its rapid brand growth and achievements in GCC, Europe, Africa, and North America. It operates principally on procuring high-quality commercial solutions with a focus primarily on hospitality, commercial and Industrial property developments for all sectors.

Our Mission:

To be a worldwide lead Brand globally by providing unparalleled quality and services while utilizing our global resources to deliver uncompromising excellence to our clients and shareholders.

Our Vision:

Is to be a globally recognized brand name that is synonymous with reliability, honesty and result driven.

Our Values:

Reliability, Sustainability, Excellence, Cost Effective, Result-Oriented



03

TOILET SERIES



09

SQUATTING PAN SERIES



15

URINAL SERIES



19

WASH BASIN SERIES



25

SHOWER TRAY SERIES



31

PUBLIC FACILITIES SERIES



41

BATHROOM FITTINGS SERIES



51

PRISON ACCESSORIES SERIES

TOILET SERIES

TOILET SERIES

BW-WC101SS



PRODUCT INFO

- Dimension: 620 x 370 x 670mm
- Made of SS304 or SS316
- Vandal proof design
- Standard accessories: Bolts / nuts

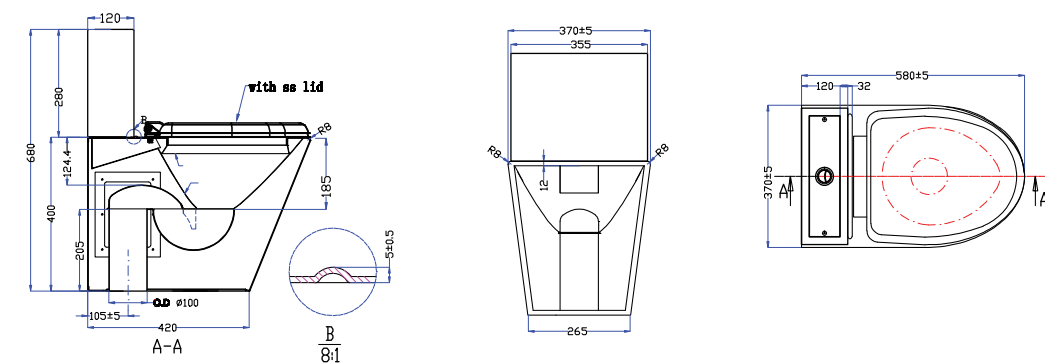

INSTALLATION INSTRUCTIONS

- Drill the screw holes/water inlet hole and drain outlet hole on the wall and floor
- Prepare external plumbing parts (not supplied)
- Put the toilet against the wall, and screw tight the bolts on the other side of the wall
- Connect well with water inlet and drain outlet

BW-WC102SS



PRODUCT INFO

- Dimension: 855 x 363 x 970mm
- Made of SS304 or SS316
- Vandal proof design, toilet comby with wash basin / nozzle / push button / cistern / paper holder
- Toilet bowl options: Central / left / right position Through wall installation
- Standard accessories : Bolts / nuts / washers / floor clip

BW-WC103SS



PRODUCT INFO

- Dimension: 800 x 455 x 928mm
- Made of SS304 or SS316
- Vandal proof design, toilet comby with wash basin/ nozzle / push button / cistern / paper holder
- Toilet bowl options: Central / left / right position Through wall installation
- Standard accessories: Bolts / nuts / washers / floor clip

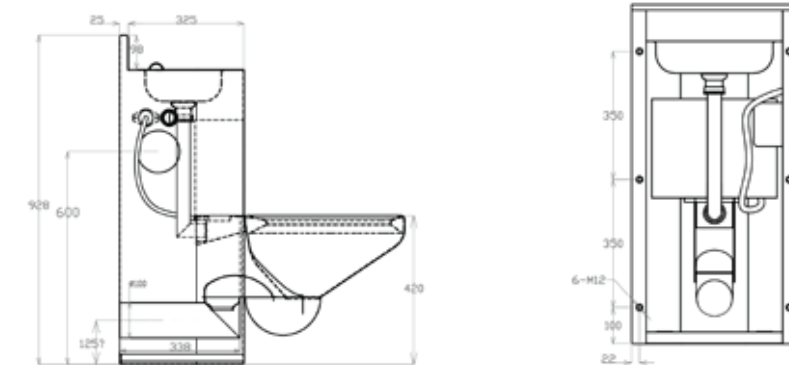
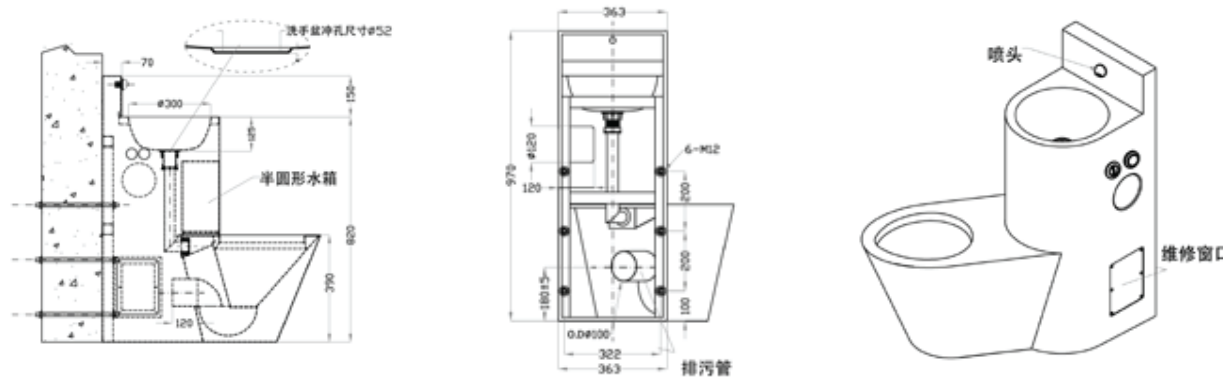

INSTALLATION INSTRUCTIONS

- Drill the screw holes/water inlet hole and drain outlet hole on the wall and floor
- Prepare external plumbing parts (not supplied)
- Put the toilet against the wall, and screw tight the bolts on the ther side of the wall
- Connect well with water inlet and drain outlet



INSTALLATION INSTRUCTIONS

- Drill the screw holes/water inlet hole and drain outlet hole on the wall and floor
- Prepare external plumbing parts (not supplied)
- Put the toilet against the wall, and screw tight the bolts on the ther side of the wall
- Connect well with water inlet and drain outlet

SQUATTING PAN SERIES

BW-SQ101SS



PRODUCT INFO

- Dimension: 490 x 490 x 213mm
- Made of SS304 or SS316
- Surface finish: Satin
- Floor mount
- P-trap or S-trap available
- I Standard accessories: Spout nozzle

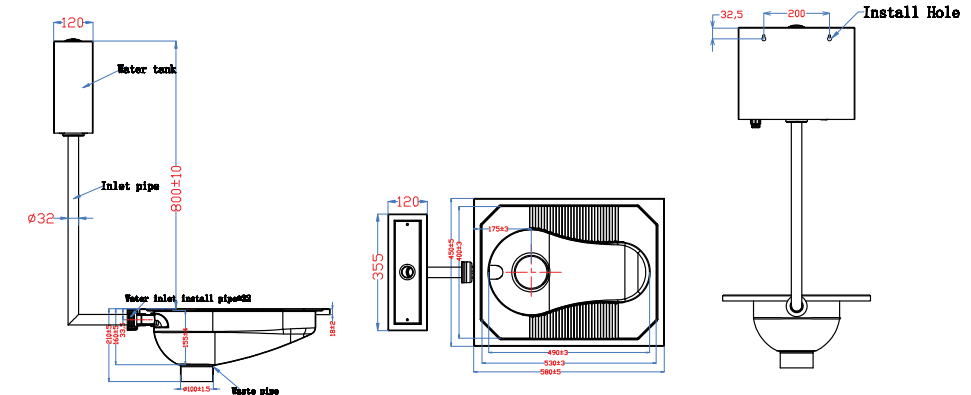

INSTALLATION INSTRUCTIONS

- Connect the spout nozzle with water inlet
- Connect the drain outlet
- Put the squatting pan into the floor slot
- Put the squatting pan into the floor slot

BW-SQ102SS



PRODUCT INFO

- Squat pan: 490 x 360 x 210mm
- Made of SS304 or SS316
- Surface finish: Satin
- Floor mount
- P-trap or S-trap available

BW-SQ103SS



PRODUCT INFO

- Dimension: 700 x 700 x 230mm
- Made of SS304 or SS316
- Surface finish: Satin
- Floor mount
- P-trap or S-trap available
- I Standard accessories: Spout nozzle

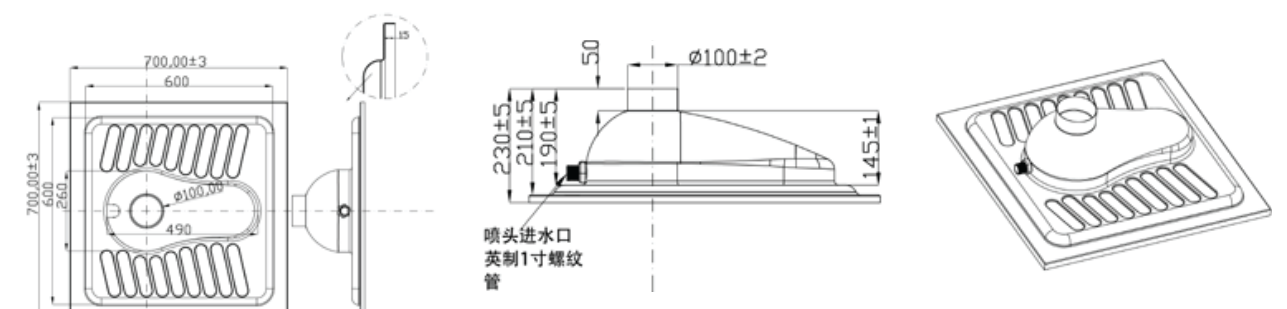
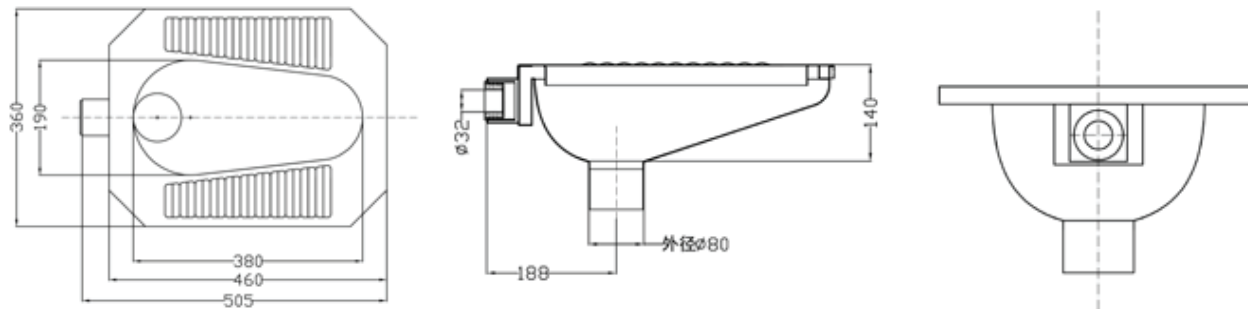

INSTALLATION INSTRUCTIONS

- Connect the spout nozzle with water inlet
- Connect the drain outlet
- Put the squatting pan into the floor slot
- Put the squatting pan into the floor slot



INSTALLATION INSTRUCTIONS

- Connect the spout nozzle with water inlet
- Connect the drain outlet
- Put the squatting pan into the floor slot
- Put the squatting pan into the floor slot

BW-SQ104SS



PRODUCT INFO

- Dimension: 690 x 430 x 257mm
- Made of SS304 or SS316
- Surface finish: Satin
- Floor mount
- P-trap or S-trap available

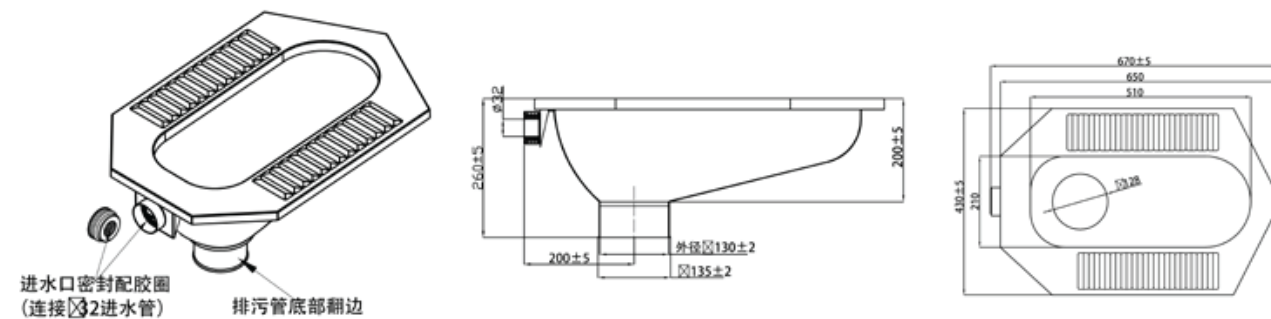

BW-SQ105SS



PRODUCT INFO

- Dimension: 580 x 450 x 200mm
- Made of SS304 or SS316
- Surface finish: Satin
- Floor mount
- P-trap or S-trap available

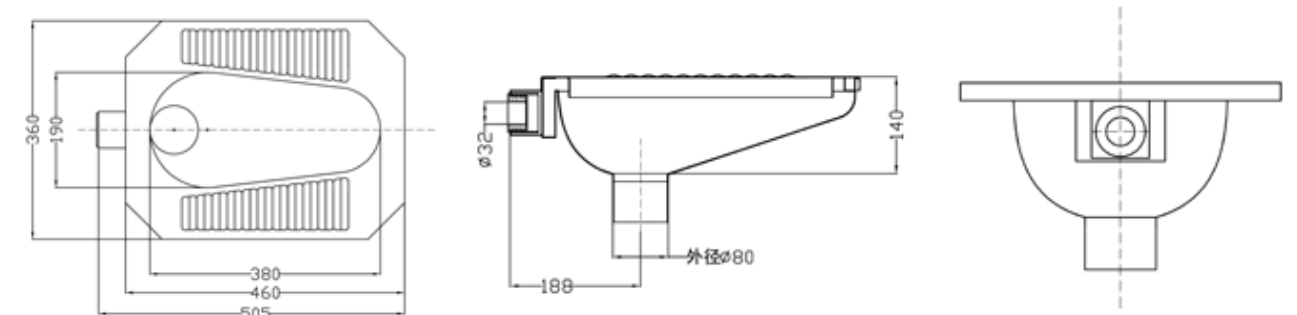

INSTALLATION INSTRUCTIONS

- Connect the spout nozzle with water inlet
- Connect the drain outlet
- Put the squatting pan into the floor slot
- Put the squatting pan into the floor slot

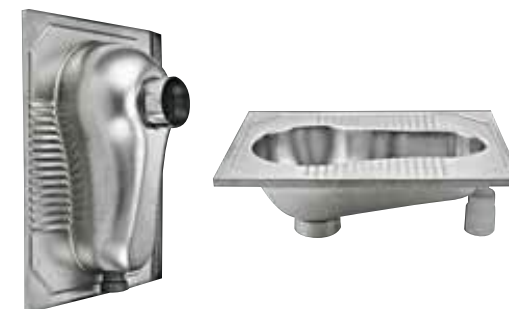

INSTALLATION INSTRUCTIONS

- Connect the spout nozzle with water inlet
- Connect the drain outlet
- Put the squatting pan into the floor slot
- Put the squatting pan into the floor slot

URINAL SERIES

URINAL SERIES

BW-UR101SS



PRODUCT INFO

- Dimension: 395 x 360 x 620mm
- Surface finish: Satin / polish / golden
- Made of SS304 or SS316
- Safety radius edge

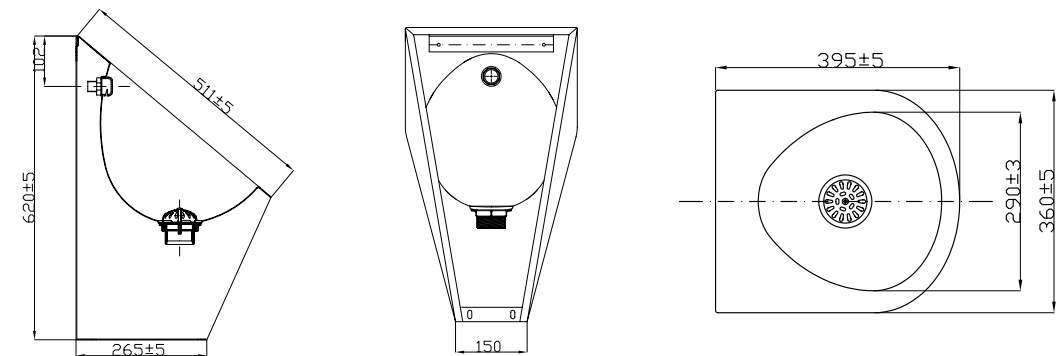

INSTALLATION INSTRUCTIONS

- Drill the screw holes / water inlet hole and drain outlet hole on the wall
- Fix the wall bracket with the supplied screws
- Put the urinal against the wall, mark down the bottom screw holes and drill the hole size ϕ 8mm
- Hang up the urinal and connect it to the water inlet and drain out let
- Fix with M8 self-tapping screw

BW-UR102SS



PRODUCT INFO

- Dimension: 296 x 295 x 390mm
- Surface finish: Satin
- Made of SS304 or SS316
- Safety radius edge

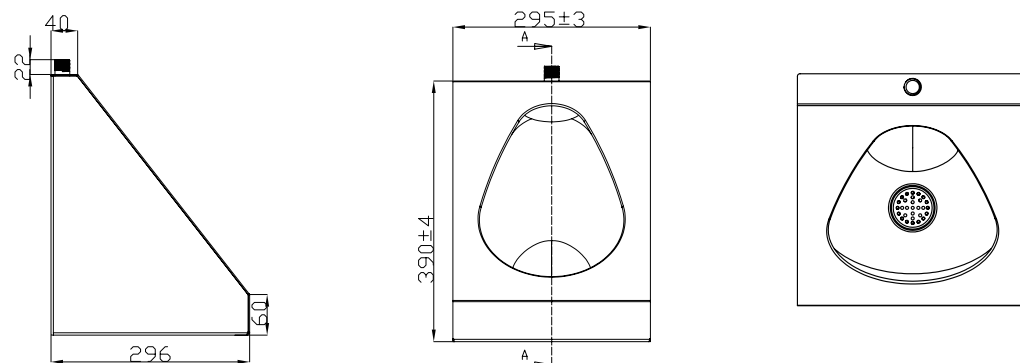

BW-UR103SS



PRODUCT INFO

- Dimension: 2400 x 240 x 545mm
- Surface finish: Satin / custom-made
- Material: SS304 or SS316
- Available size: 600 / 900 / 1200 / 1500 / 1800 / 2100 / 2400mm

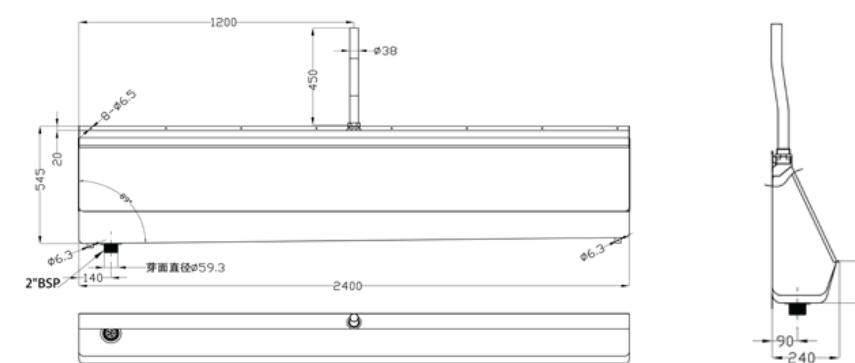

INSTALLATION INSTRUCTIONS

- Drill the screw holes / water inlet hole and drain outlet hole on the wall
- Fix the wall bracket with the supplied screws
- Put the urinal against the wall, mark down the bottom screw holes and drill the hole size ϕ 8mm
- Hang up the urinal and connect it to the water inlet and drain out let
- Fix with M8 self-tapping screw

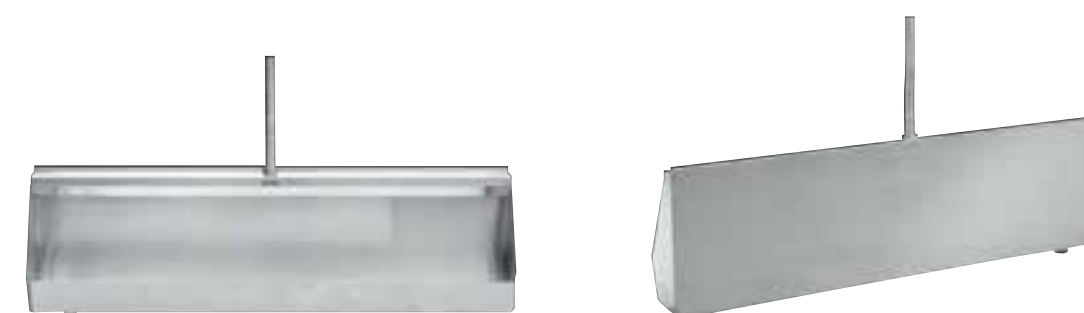

WASH BASIN SERIES

WASH BASIN SERIES

BW-WB101SS



PRODUCT INFO

- Dimension: 530 x 426 x 185mm
- Surface finish: Satin
- Made of SS304 or SS316
- Safety radius edge

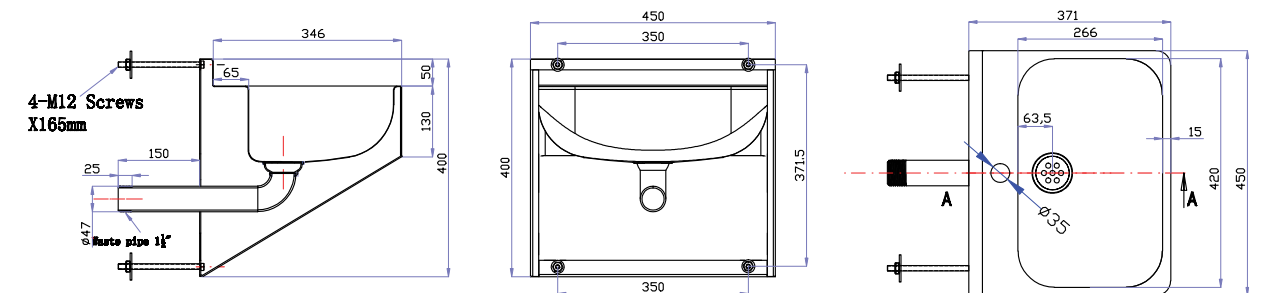

INSTALLATION INSTRUCTIONS

- Drill holes on the wall, hole distance is based on the actual size of the mounting screw that shows behind the basin, Holes need to penetrate the wall
- Fix the mounting screw into the wash basin, install the drain fittings into the basin, connect the drain fittings with drain outlet pipe
- Install the basin on the wall, connect the drain outlet pipe, connect the faucet water inlet pipe

BW-WB102SS



PRODUCT INFO

- Dimension: 455 x 395 x 358mm
- Surface finish: Satin / custom-made
- Made of SS304 or SS316

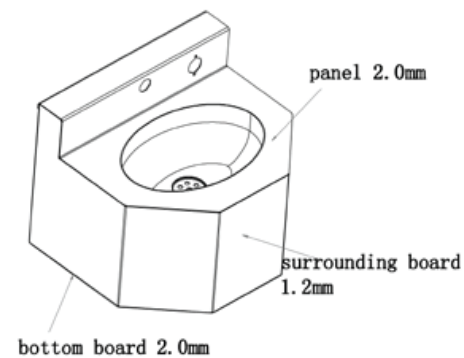

BW-WB103SS



PRODUCT INFO

- Dimension: 450 x 350 x 400mm
- Surface finish: Satin
- Made of SS304 or SS316
- Safety radius edge

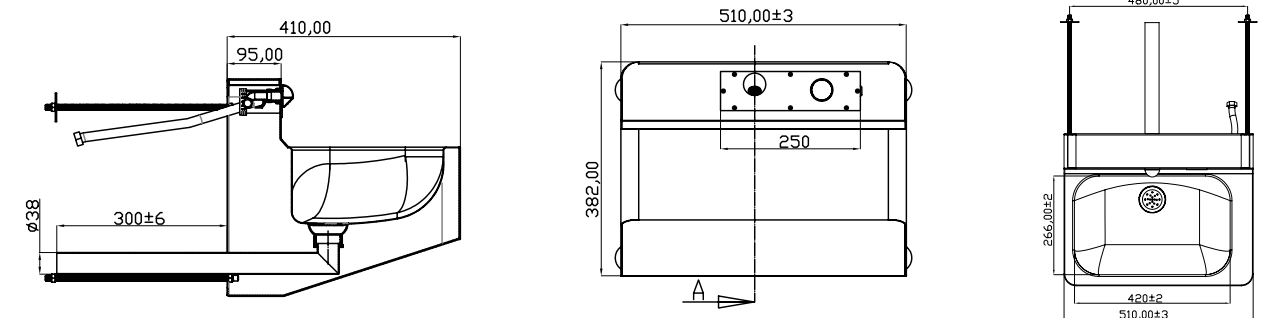

INSTALLATION INSTRUCTIONS

- Drill holes on the wall, hole distance is based on the actual size of the mounting screw that shows behind the basin, Holes need to penetrate the wall
- Fix the mounting screw into the wash basin, install the drain fittings into the basin, connect the drain fittings with drain outlet pipe
- Install the basin on the wall, connect the drain outlet pipe, connect the faucet water inlet pipe

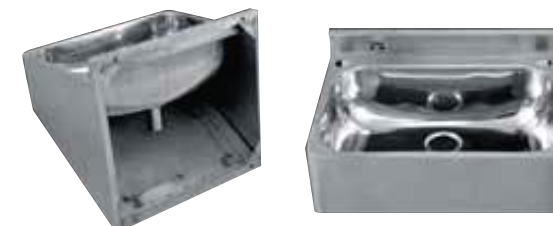

INSTALLATION INSTRUCTIONS

- Drill holes on the wall, hole distance is based on the actual size of the mounting screw that shows behind the basin, Holes need to penetrate the wall
- Fix the mounting screw into the wash basin, install the drain fittings into the basin, connect the drain fittings with drain outlet pipe
- Install the basin on the wall, connect the drain outlet pipe, connect the faucet water inlet pipe

BW-WB104SS



PRODUCT INFO

- Dimension: 450 x 350 x 950mm
- Surface finish: Satin
- Made of SS304 or SS316

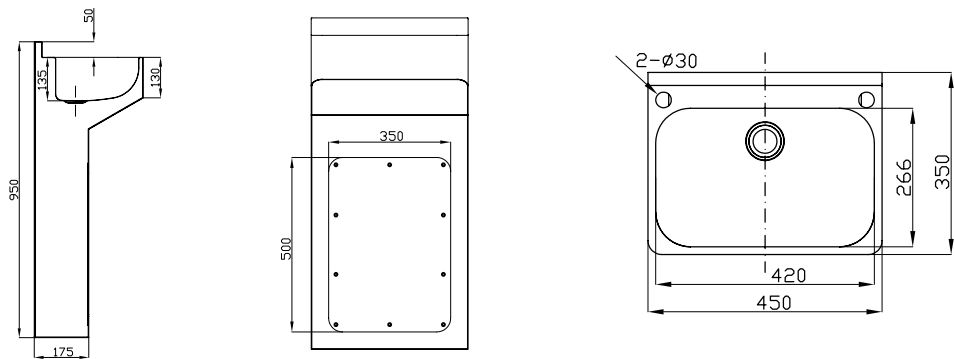

INSTALLATION INSTRUCTIONS

- Drill holes on the wall, hole distance is based on the actual size of the mounting screw that shows behind the basin, Holes need to penetrate the wall
- Fix the mounting screw into the wash basin, install the drain fittings into the basin, connect the drain fittings with drain outlet pipe
- Install the basin on the wall, connect the drain outlet pipe, connect the faucet water inlet pipe

BW-WB105SS



PRODUCT INFO

- Dimension: 690 x 430 x 257mm
- Made of SS304 or SS316
- Surface finish: Satin
- Floor mount
- P-trap or S-trap available

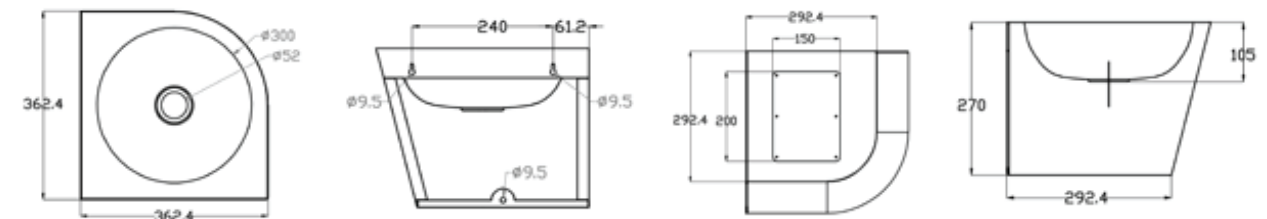

INSTALLATION INSTRUCTIONS

- Drill holes on the wall, hole distance is based on the actual size of the mounting screw that shows behind the basin, Holes need to penetrate the wall
- Fix the mounting screw into the wash basin, install the drain fittings into the basin, connect the drain fittings with drain outlet pipe
- Install the basin on the wall, connect the drain outlet pipe, connect the faucet water inlet pipe

SHOWER TRAY SERIES



BW-ST101SS



PRODUCT INFO

- Dimension: 800 x 800 x 115mm
- Surface finish: Satin
- Made of SS304 or SS316
- Vandal resistance, Long lifespan

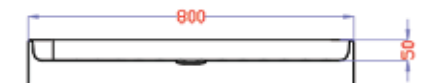
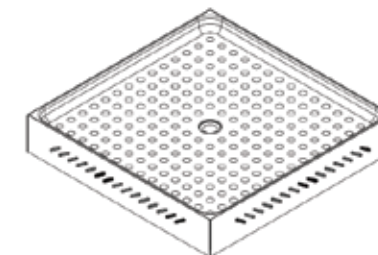
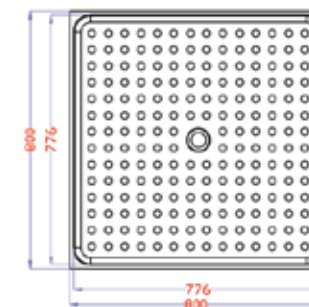

INSTALLATION INSTRUCTIONS

- Fit the shower lining leaving a 6mm gap between the shower tray rebate and the bottom of the impervious lining
- Use a temporary 6mm packer to ensure an even 6mm gap
- Impervious shower lining is fixed directly to the plasterboard in strict accordance with the lining manufactured edge to the bottom

BW-ST102SS



PRODUCT INFO

- Dimension: 700 x 700 x 98mm
- Surface finish: Satin
- Made of SS304 or SS316
- Vandal resistance, Long lifespan

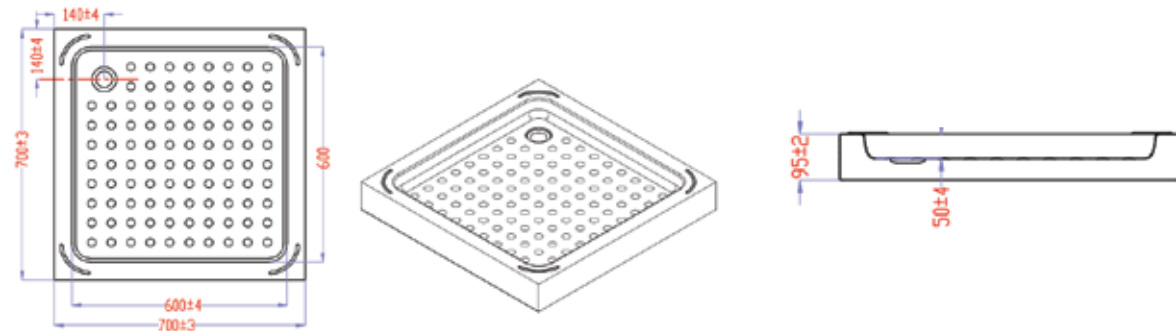

BW-ST103SS

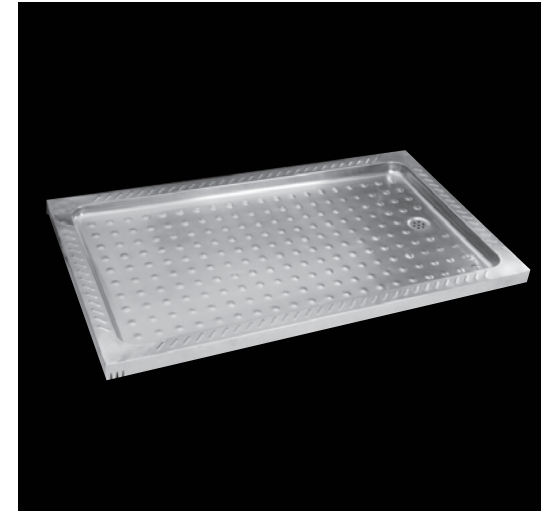

PRODUCT INFO

- Dimension: 1200 x 700 x 125mm
- Surface finish: Satin
- Made of SS304 or SS316
- Vandal resistance, Long lifespan

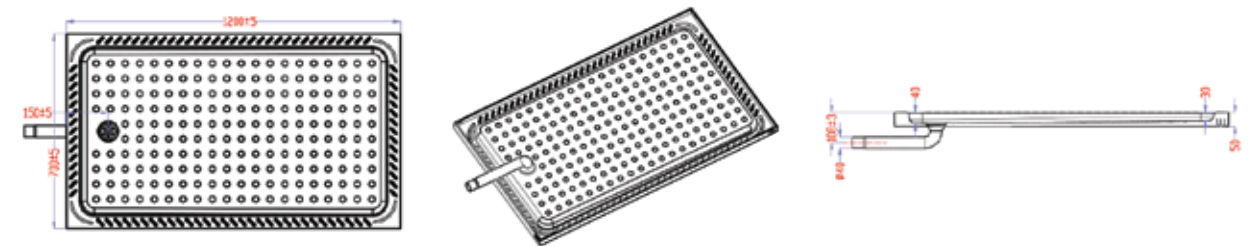

INSTALLATION INSTRUCTIONS

- Fit the shower lining leaving a 6mm gap between the shower tray rebate and the bottom of the impervious lining
- Use a temporary 6mm packer to ensure an even 6mm gap
- Impervious shower lining is fixed directly to the plasterboard in strict accordance with the lining manufactured edge to the bottom



INSTALLATION INSTRUCTIONS

- Fit the shower lining leaving a 6mm gap between the shower tray rebate and the bottom of the impervious lining
- Use a temporary 6mm packer to ensure an even 6mm gap
- Impervious shower lining is fixed directly to the plasterboard in strict accordance with the lining manufactured edge to the bottom

BW-ST104SS

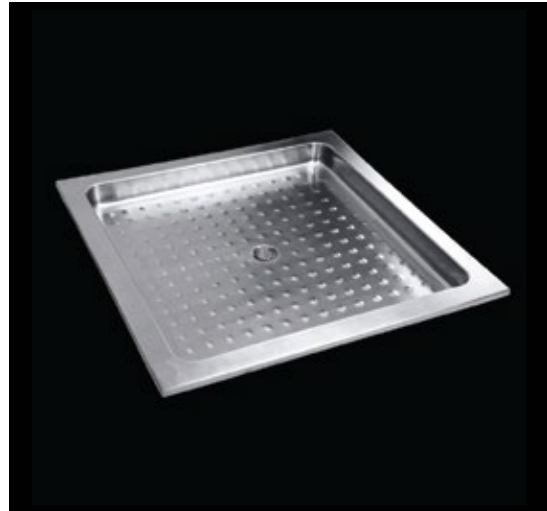

PRODUCT INFO

- Dimension: 900 x 900 x 125mm
- Surface finish: Satin
- Made of SS304 or SS316
- Vandal resistance, Long lifespan

BW-ST105SS



PRODUCT INFO

- Dimension: 750 x 750 x 125mm
- Surface finish: Satin
- Made of SS304 or SS316
- Vandal resistance, Long lifespan

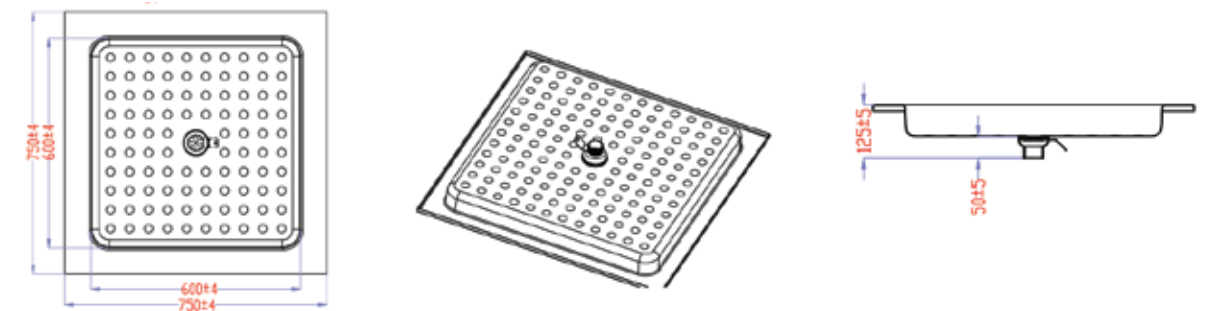
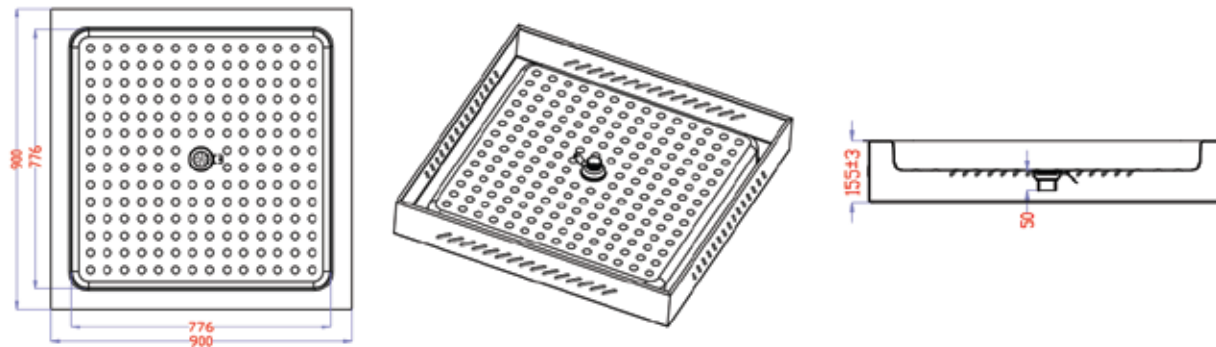

INSTALLATION INSTRUCTIONS

- Fit the shower lining leaving a 6mm gap between the shower tray rebate and the bottom of the impervious lining
- Use a temporary 6mm packer to ensure an even 6mm gap
- Impervious shower lining is fixed directly to the plasterboard in strict accordance with the lining manufactured edge to the bottom



INSTALLATION INSTRUCTIONS

- Fit the shower lining leaving a 6mm gap between the shower tray rebate and the bottom of the impervious lining
- Use a temporary 6mm packer to ensure an even 6mm gap
- Impervious shower lining is fixed directly to the plasterboard in strict accordance with the lining manufactured edge to the bottom

PUBLIC FACILITIES SERIES

BW-PBF101SS



PRODUCT INFO

- Dimension: 1500 x 700 x 1050mm (Can be Customized)
- Material: 304 / 316 SUS
- Surface finish: Satin / Polish

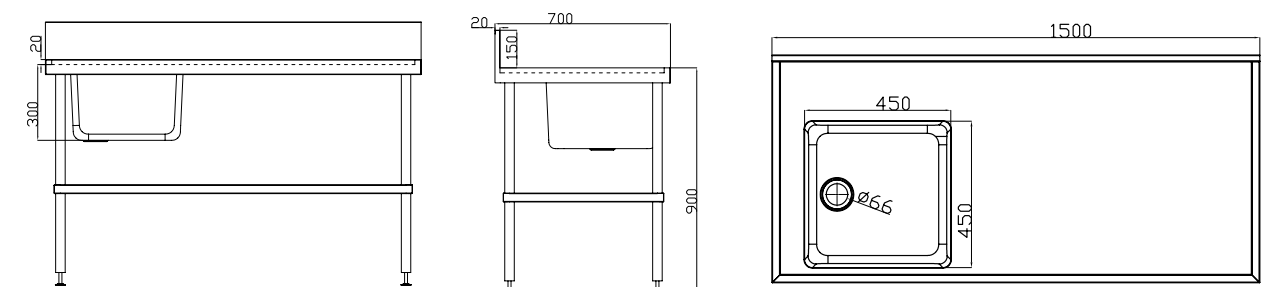

WIDE APPLICATION

- Water deficient areas, Public locations, Ships, Schools, Hospitals, and so on

FEATURE

- Easy wasing, Environmental, Portable, Durable

BW-PBF102SS



PRODUCT INFO

- Dimension: 1500 x 700 x 1050mm (Can be customized)
- Material: 304 / 316 SUS
- Surface finish: Satin/ polish

BW-PBF103SS



PRODUCT INFO

- Dimension: 1828 x 410 x 430mm (Can be customized)
- Material: 304 / 316 SUS
- Surface finish: Satin / polish

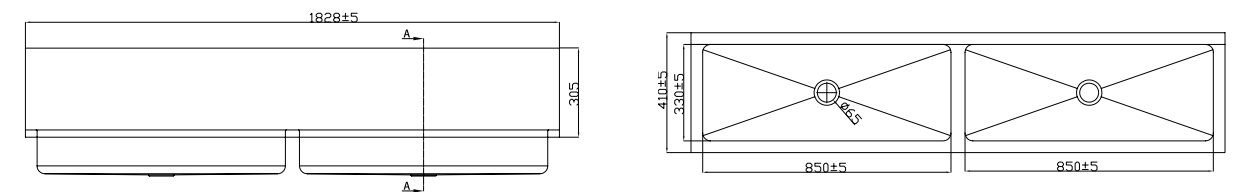
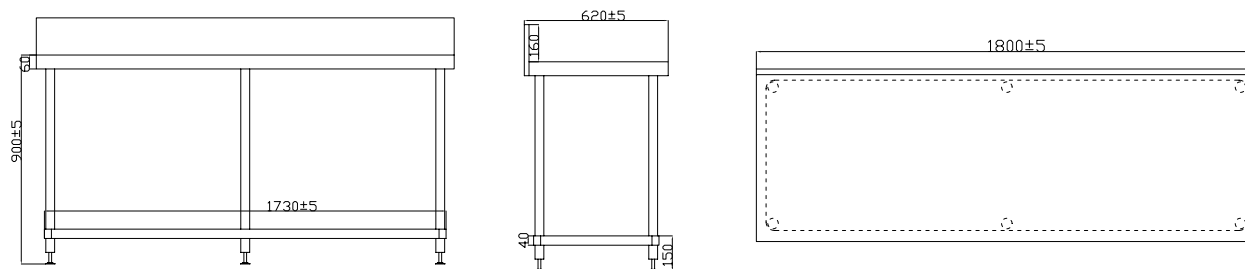

WIDE APPLICATION

- Water deficient areas, Public locations, Ships, Schools, Hospitals, and so on

FEATURE

- Easy wasing, Environmental, Portable, Durable



WIDE APPLICATION

- Catering Canteen, Restaurant, Hotel, School, Home

BW-PBF104SS



PRODUCT INFO

- Dimension: 1500 x 600 x 985mm (Can be customized)
- Material: 304 / 316 SUS
- Surface finish: Satin / polish

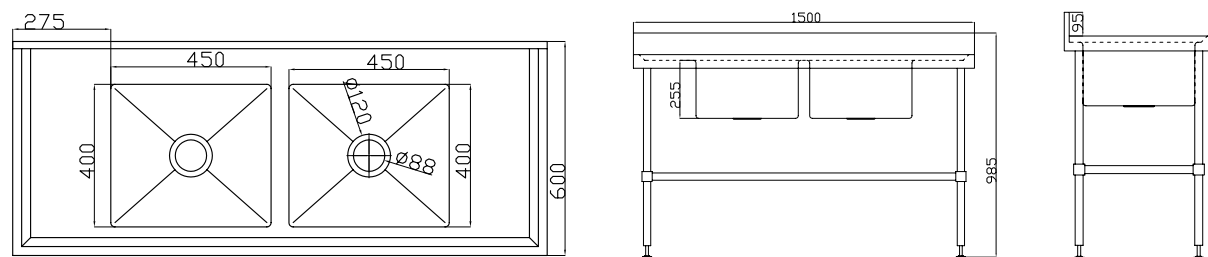

WIDE APPLICATION

- Catering Canteen, Restaurant, Hotel, School, Home

BW-PBF105SS



PRODUCT INFO

- Dimension: 835 x 510 x 780mm (Can be customized)
- Material: 304 / 316 SUS
- Surface finish: Satin / polish

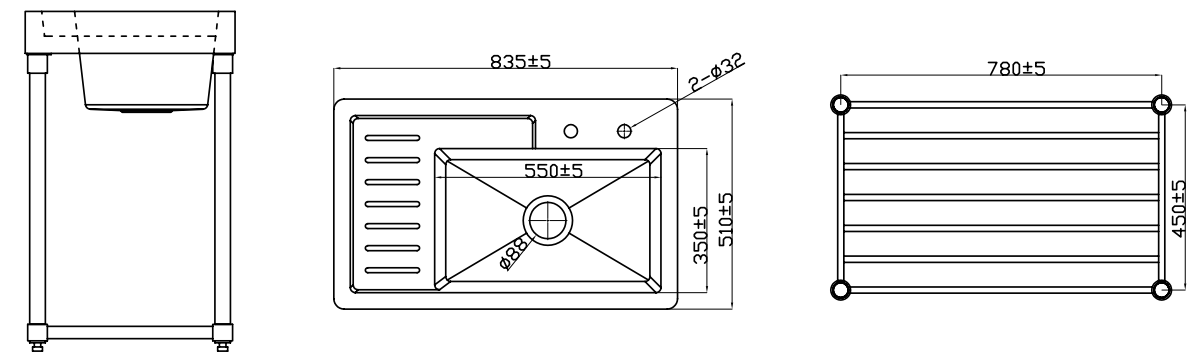

WIDE APPLICATION

- Catering Canteen, Restaurant, Hotel, School, Home

BW-PBF106SS



PRODUCT INFO

- Dimension: 900 x 380 x 300mm (Can be customized)
- Material: 304 / 316 SUS
- Surface finish: Satin / polish

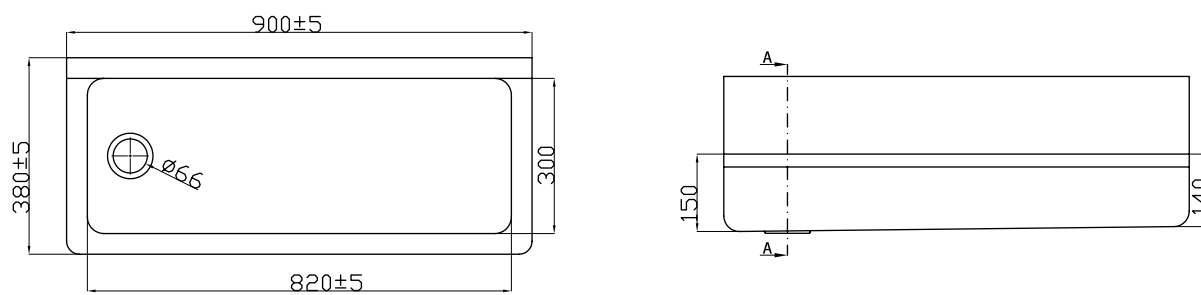

WIDE APPLICATION

- Water deficient areas, Public locations, Ships, Schools, Hospitals, and so on

FEATURE

- Easy wasing, Environmental, Portable, Durable

BW-PBF107SS



PRODUCT INFO

- Dimension: Gas stove oven area: 3540 x 610mm
- work table: 2405 x 500mm
- Sink area: 2300 x 600mm
- Material: 304 / 316 SUS
- Bench: 2500 x 500mm (Can be customized)
- Surface finish: Satin / polish

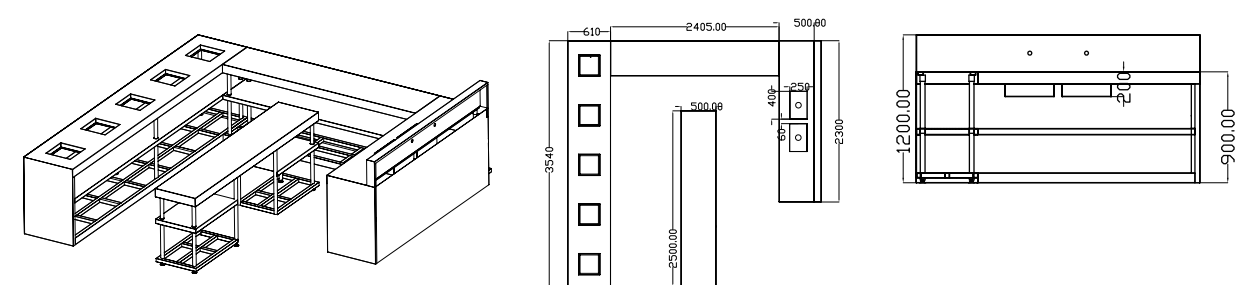

BW-PBF108SS



PRODUCT INFO

- Dimension: 1830 x 1030mm (Can be customized)
- Material: 304 / 316 SUS
- Surface finish: Satin / polish

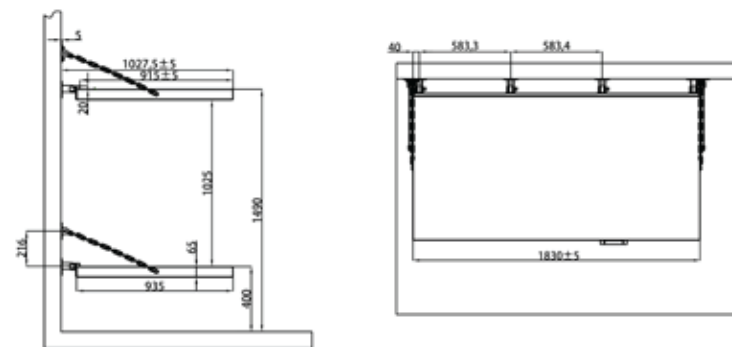

BW-PBF109SS



PRODUCT INFO

- Dimension: 2150 x 340 x 450mm (Can be customized)
- Material: 304 / 316 SUS
- Surface finish: Satin / polish

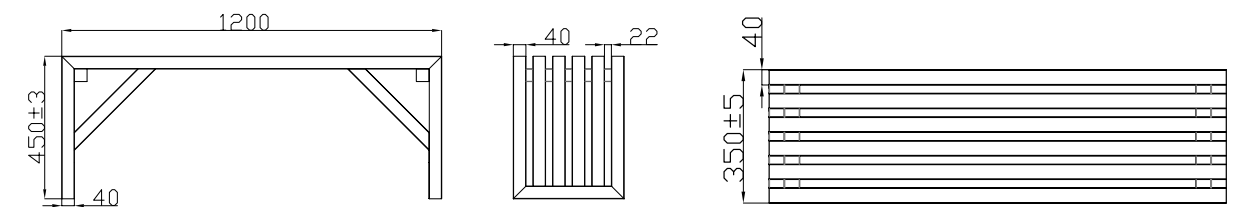

BATHROOM FITTINGS SERIES

BW-BF101SS



PRODUCT INFO

- Product Name: Flush push button
- Dimension: 150 x 150mm
- Made of SS304: Vandal proof design
- Wall mount
- Flow rate: 40 seconds
- Water outlet/inlet: 1/2" thread

BW-BF102SS



PRODUCT INFO

- Product Name: Flush push button
- Dimension: 270 x 150mm
- Made of SS304: Vandal proof design
- Wall mount
- Flow rate: 8-12 seconds
- Water outlet/inlet: 1/2" thread

BW-BF103SS



PRODUCT INFO

- Product Name: Stainless Steel automatic toilet flusher
- Made of SS304: Vandal proof design
- Surface finish : Brush
- Concealed mounted
- Flush type: Sensor

BW-BF105SS



PRODUCT INFO

- Product Name: Hook
- Surface finish: polish
- Made of SS304: Vandal proof design
- Made of SS304 or SS316
- Wall mount

BW-BF104SS



PRODUCT INFO

- Product Name: Stainless Steel automatic toilet flusher
- Made of SS304: Vandal proof design
- Surface finish : Brush
- Concealed mounted
- Flush type: Sensor

BW-BF106SS



PRODUCT INFO

- Product Name: Hook
- Surface finish : polish
- Made of SS304: Vandal proof design
- Made of SS304 or SS316
- Wall mount

BW-BF107SS



PRODUCT INFO

- Product Name: Bathroom mirror
- Dimension: 400 x 300x1.2mm
- Made of SS304: Vandal proof design
- Surface finish: Satin
- Wall mount

BW-BF109SS



PRODUCT INFO

- Product Name: Basin faucets
- Made of SS304: Vandal proof design
- Surface finish: Chrome
- Sensor

BW-BF108SS



PRODUCT INFO

- Product Name: Bathroom mirror
- Dimension: 400 x 300 x 7mm
- Made of SS304: Vandal proof design
- Surface finish: Satin
- Wall mount

BW-BF110SS



PRODUCT INFO

- Product Name: Basin faucets
- Made of SS304: Vandal proof design
- Surface finish: Brush / polish

BW-BF11SS



PRODUCT INFO

- Product Name: Hand dryer
- Surface finish: Chrome
- Made of SS304: Vandal proof design
- Deck mount

BW-BF113SS



PRODUCT INFO

- Product Name: Towel holder
- Dimension: Length 500mm-600mm
- Made of SS304: Vandal proof design
- Surface finish: Satin / polish
- Wall mount

BW-BF112SS



PRODUCT INFO

- Product Name: Hand dryer
- Surface finish: Chrome
- Made of SS304: Vandal proof design
- Wall mount

BW-BF114SS



PRODUCT INFO

- Product Name: Towel holder
- Dimension: Length 500mm-600mm
- Made of SS304: Vandal proof design
- Surface finish: Satin / polish
- Wall mount

BW-BF115SS



PRODUCT INFO

- Product Name: Paper holder
- Dimension: 315 x 165 x 90mm
- Made of SS304: Vandal proof design
- Surface finish: Polish
- Wall mount

BW-BF117SS



PRODUCT INFO

- Product Name: Bidet spray
- Made of SS304: Vandal proof design
- Surface finish: Copper

BW-BF116SS

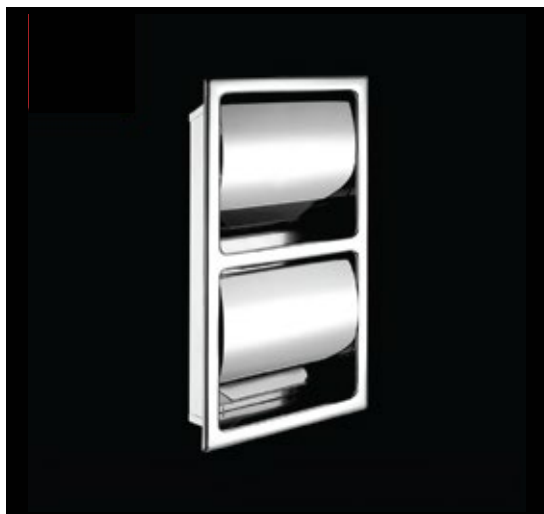

PRODUCT INFO

- Product Name: Paper holder
- Dimension: 140 x 315 x 75mm
- Made of SS304: Vandal proof design
- Surface finish: Polish
- Wall mount

BW-BF118SS



PRODUCT INFO

- Product Name: Bidet spray
- Made of SS304: Vandal proof design
- Surface finish: Chrome

PRISON ACCESSORIES SERIES

4 - MAN PEDESTAL TABLE

SPECIFICATIONS&OPTIONS

Our Pedestal Table is fabricated with a 12 gauge top and 14 gauge seats. 3" square tube seat supports weld to the 4" square main tube pedestal which mounts to a 3/8" base plate. Tables typically ship fully assembled with a factory primer finish and warrantee to match your project specifications. This unit can be either bolted in place or welded to one of our many embed designs upon request. Options include mild steel or stainless steel seat tops, powder coat finish, 4, 6, and 8 seat configurations, engineered to your project' s specifications.

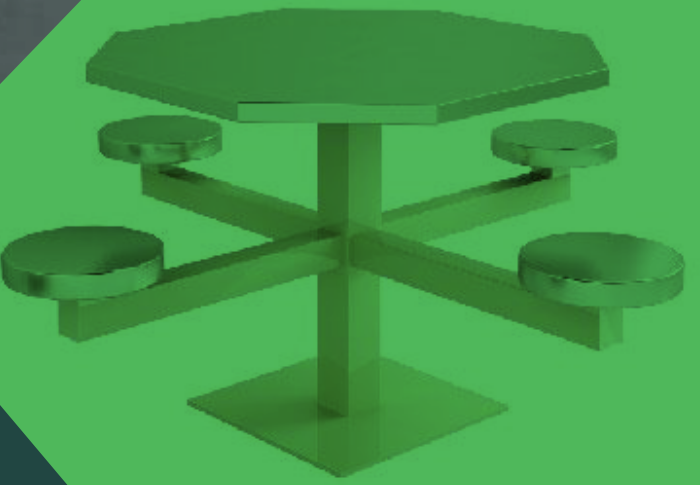
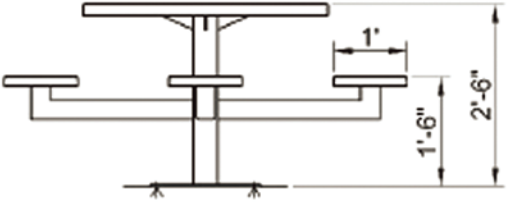
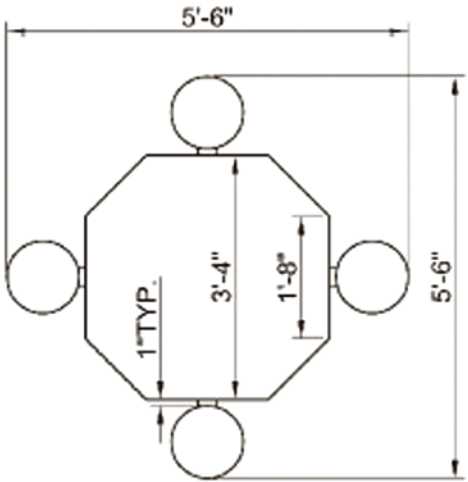

BENCH TABLE

SPECIFICATIONS&OPTIONS

Designed for heavy duty institutional seating needs. Tops and benches are 10 gauge, vertical support is constructed of 7 gauge formed channels. Seat support is 2" x3" x3/16" angle. Features include prime finish, bolted or welded in place, shipped fully assembled, and warrantee to match project specifications. Options include powder coat finish available, seat top can be mild steel or stainless, available in 4, 6 and 8 seat configurations, embedded sublimation image available, and engineered to your projects specifications.

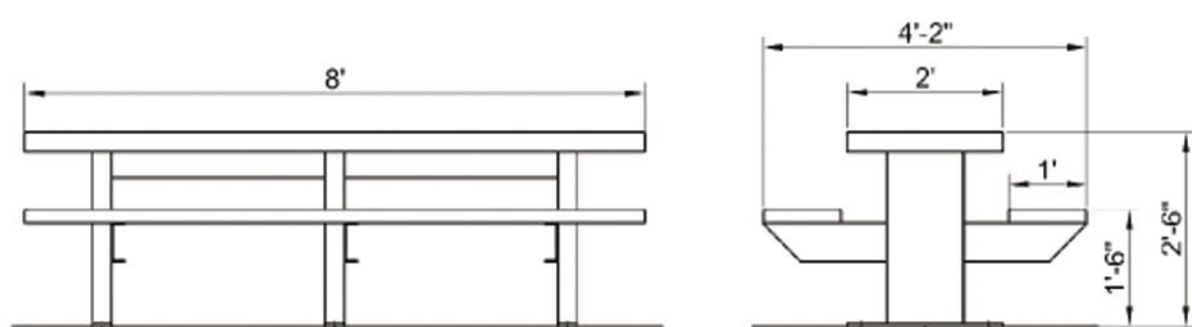

FLOOR MOUNTED DESK

SPECIFICATIONS&OPTIONS

Our Floor Mounted Desk incorporates a 10 gauge steel top held up with 2" x2" x3/16" tube supports. It comes with a 12" diameter seat (either single or double configuration) that is supported by a 3/8" x4" arm which swivels out of the way when needed. Standard 14 gauge seat tops can be provided in both mild and stainless steel. We primer finish all mild steel (#4 finish stainless steel top optional). Two optional shelves constructed of 12 gauge steel may also be provided. A warrantee can also be matched to product specifications. Options include mild steel or stainless steel seat top, available powder coat finish, engineered to your project's specifications.

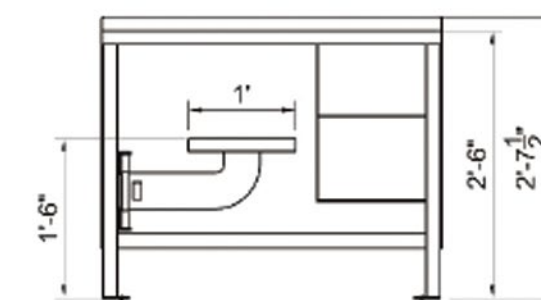
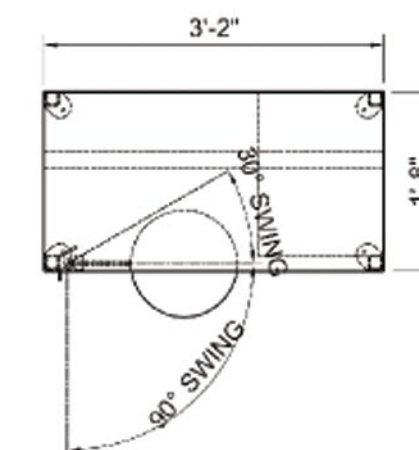

WALL MOUNTED DESK

SPECIFICATIONS&OPTIONS

Our Wall Mounted Desk is fabricated from one piece of 10 gauge steel with sides flanged and edges ground smooth. We primer finish all mild steel (4#finish stainless steel top optional). This unit can be either bolted in place or welded to one of our many embed designs upon request. A warrantee can also be matched to product specifications. Options include mild steel or stainless steel seat top, available powder coat finish, engineered to your project's specifications.

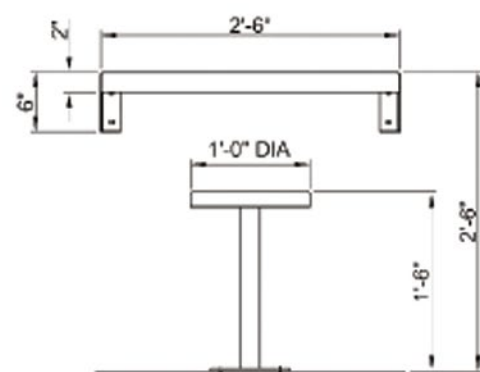
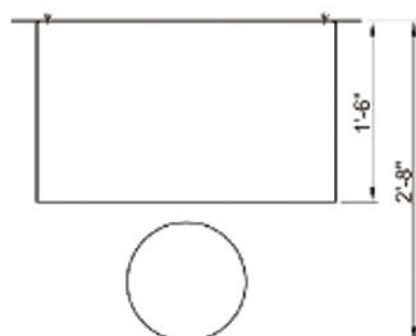

FLOOR MOUNTED SINGLE BUNK

SPECIFICATIONS&OPTIONS

Single Bunk with 2" x 2" x 3/16" angle legs is anchored with 3/16" corner-less pads. Bed pan is 10 gauge steel hemmed front and back for strength and to eliminate sharp edges. Features include prime finish, bolt down or weld in place, shipped fully assembled, and warrantee to match project specifications. Options include 14 gauge drawers with hasp for paddle lock, powder-coat finish available, and custom engineered to your projects specifications.

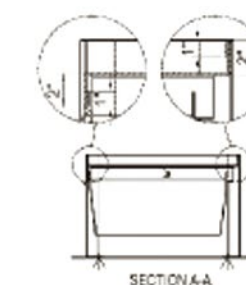
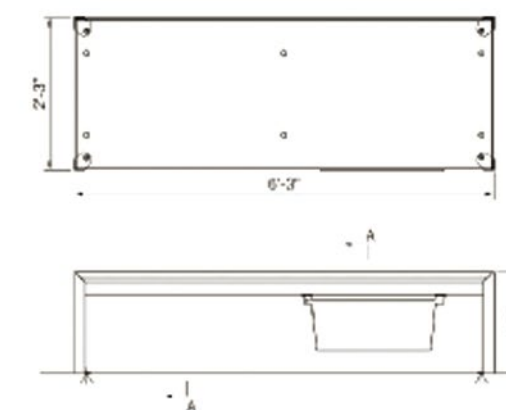

FLOOR MOUNTED DOUBLE BUNK

SPECIFICATIONS&OPTIONS

Double Bunk with 2" x 2" x 3/16" angle legs is anchored with 3/16" corner-less pads. Bed pan is 10 gauge steel hemmed front and back for strength and to eliminate sharp edges. Features include prime finish, bolt down or weld in place, shipped fully assembled, and warrantee to match project specifications. Options include 14 gauge drawers with hasps for the paddle locks, optional ladder made with 2" x 2" x 3/16" angle, powder-coat finish, and custom engineered to your projects specifications.

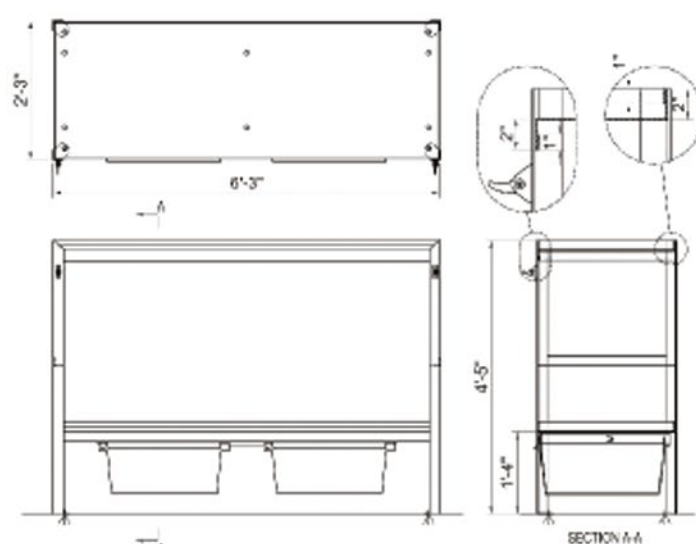

WALL MOUNTED BUNK

SPECIFICATIONS&OPTIONS

Wall mounted bunk fabricated with 3/16" end gussets hemmed and ground to remove all sharp edges. Bedpan is 10 gauge steel hemmed front and back. Features include prime finish, bolt down or weld in place, shipped fully assembled, and warrantee to match project specifications. Options include 14 gauge drawer with hasp for pad lock, optional ladder made with 2" x 2" x 3/16" angle, powder-coat finish, and custom engineered to your projects specifications.

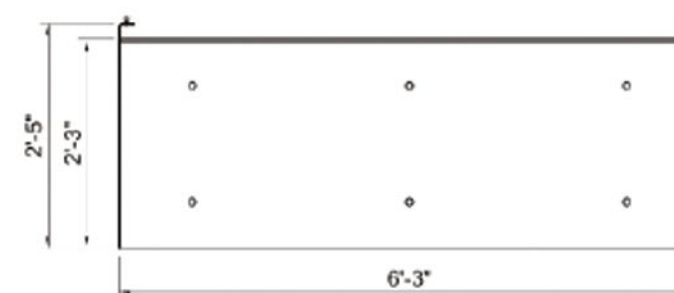

FLOOR MOUNTED STOOL

SPECIFICATIONS&OPTIONS

Our Floor Mounted Stool sits 18" high & is designed for heavy duty institutional seating needs. The pedestal support is a 2 1/2" tube welded to a 10 gauge seat top backing plate and 1/4" thick 8" X 8" anchor plate. Standard 14 gauge seat tops can be provided in both mild and stainless steel. We primer finish all mild steel (#4 finish stainless steel top optional). This unit can be either bolted or welded in place. A warrantee can also be matched to product specifications. Options include mild steel or stainless steel seat top, available powder coat finish, engineered to your project's specifications.

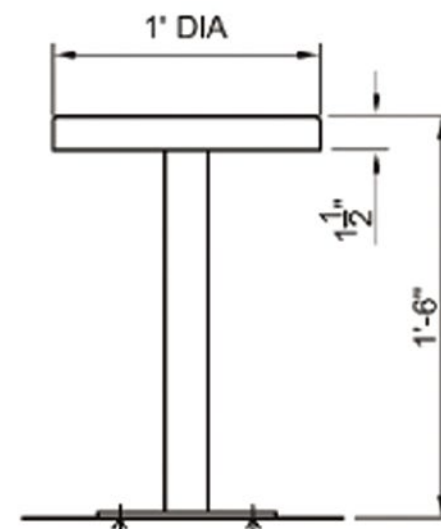

FLOOR MOUNTED BENCH

SPECIFICATIONS&OPTIONS

Our Mounted Bench is constructed of a 12" wide 10 gauge steel top with flanges on all four sides. The mounting gussets are fabricated from 3/16" mild steel or tube and spaced 3' -0" on center. We primer finish all mild steel (#4 finish stainless steel top optional). And a warrantee can also be matched to product specifications. Options include mild steel or stainless steel seat top, available powder coat finish, engineered to your project's specifications.

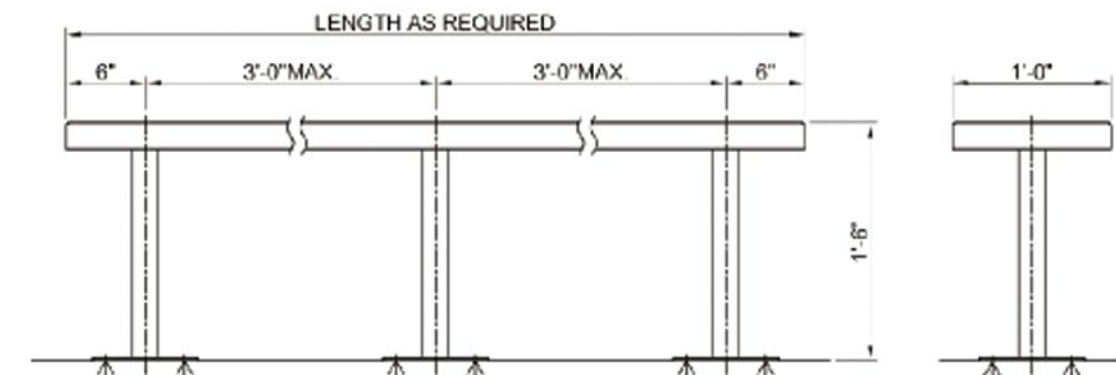

WALL MOUNTED SWING STOOL

SPECIFICATIONS&OPTIONS

Our Wall Mounted Stool is designed for heavy duty institutional seating needs. The swing arm is constructed of 3/8" steel plate and is welded to a 10 gauge seat top backing plate and the swing apparatus. Standard 14 gauge seat tops can be provided in both mild and stainless steel. We primer finish all mild steel (4# finish stainless steel top optional). This unit can be either bolted in place or welded to one of our many embed designs upon request. Steel seat stops are provided in order to give maximum swing circumference. A warrantee can also be matched to product specifications. Options include mild steel or stainless steel seat top, available powder coat finish, engineered to your project's specifications.

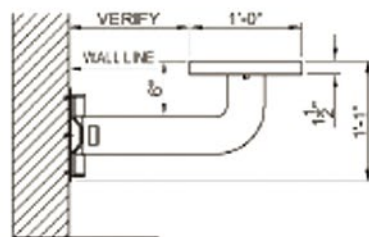
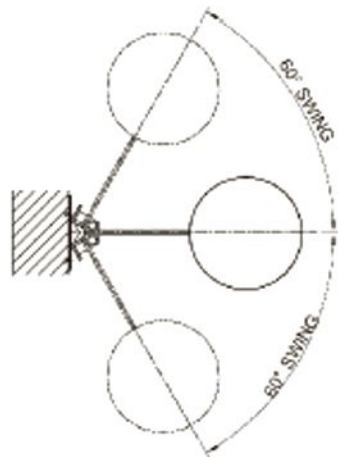

WALL MOUNTED STOOL

SPECIFICATIONS&OPTIONS

Our Wall Mounted Stool is designed for heavy duty institutional seating needs. The 2" x3" .120 wall square tube is welded to a 10 gauge seat top backing plate and 1/4" thick wall anchor plate. Standard 14 gauge seat tops can be provided in both mild and stainless steel. We primer finish all mild steel (#4 finish stainless steel top optional). This unit can be either bolted in place or welded to one of our many embed designs upon request. A warrantee can also be matched to product specifications. Options include mild steel or stainless steel seat top, available powder coat finish, engineered to your project's specifications.

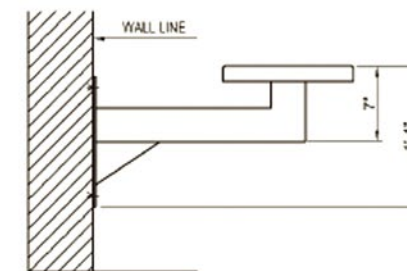
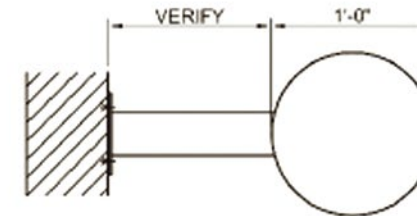

MODESTY PANEL

SPECIFICATIONS&OPTIONS

Our modesty panels can be fabricated to your job specifications with a brushed or coated steel finish, and a powder coat optional. Options of tubular or angle type support are available, engineered and warranted to match your project specifications.

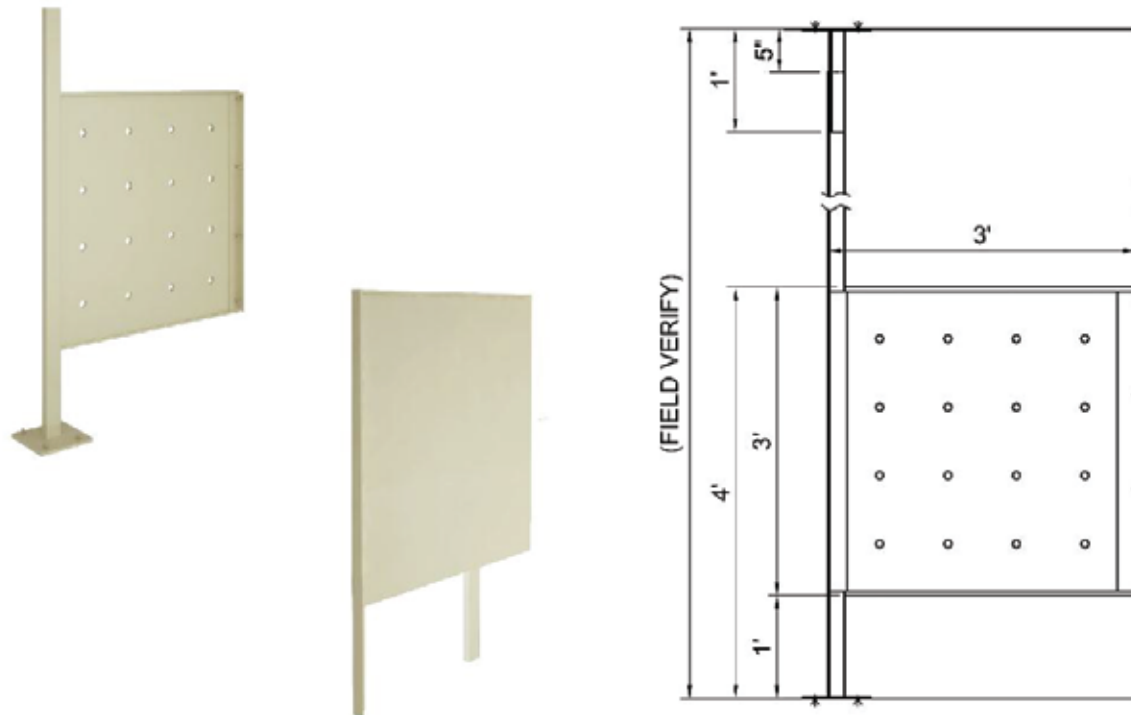

ACCESS PANEL

SPECIFICATIONS&OPTIONS

Our lift-out access panel is fabricated from 10 gauge steel panels and 7 gauge steel plate frame. The lift-out access panels secures to areas such as utility or plumbing, features include deadlock, specific anchor requirements to wall construction and warranted to match project specifications.

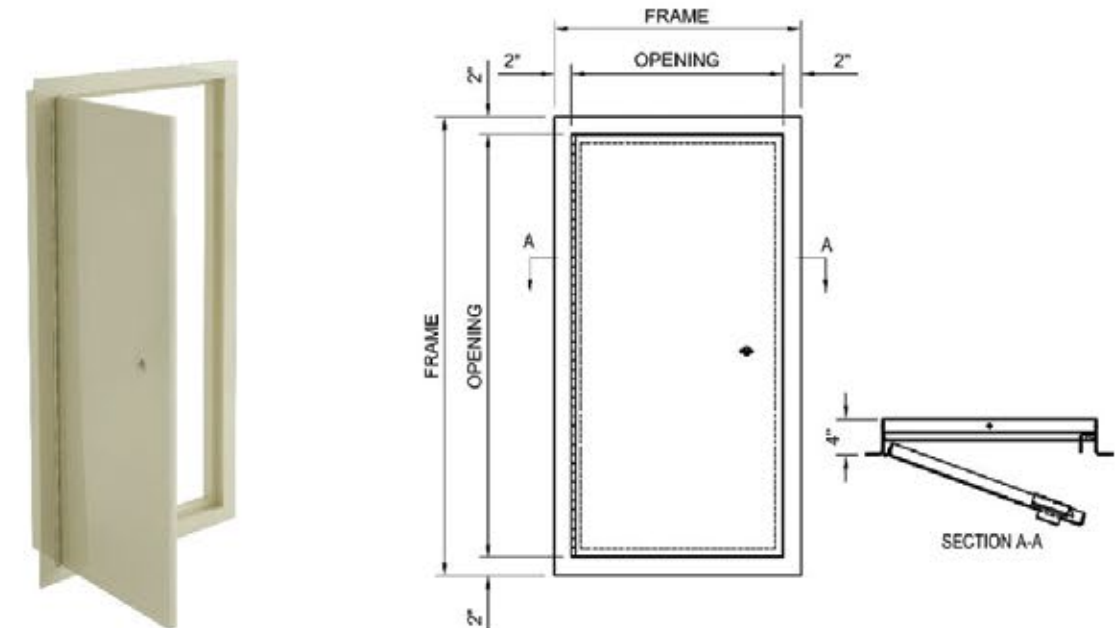

FOOD PASS

SPECIFICATIONS&OPTIONS

Food Pass is constructed with 3/16" mild steel and is fully customizable to fit your application. Features include 10 gauge mild steel keeper, cast steel latch, and warrantee to match project specifications. Options include applicability on many different types of doors and multiple latch system options.

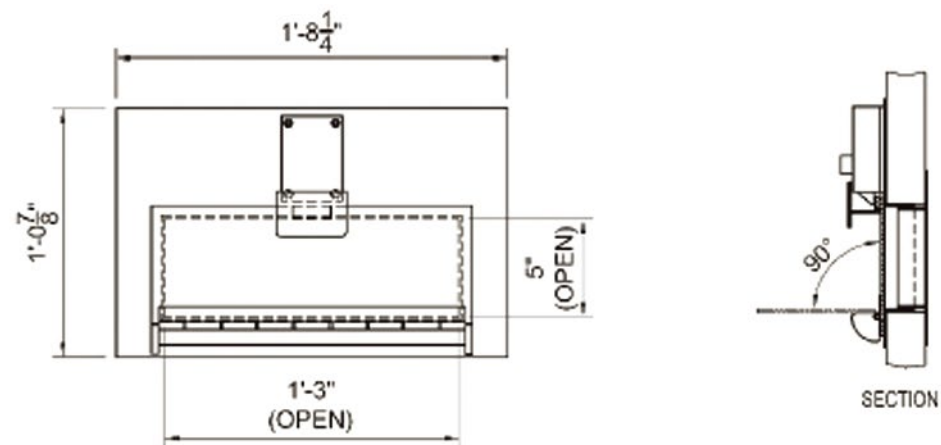

PISTOL LOCKER

SPECIFICATIONS&OPTIONS

Our Pistol Locker is constructed of 10 gauge mild steel. Standard units are available in 3, 6, and 12 compartments. The drawers are lined with moth-proof felt, and can be provided with cam or snap locks as required. The continuous mounting angle provided is shipped loose to accommodate surface or flush mounting applications. A warrantee can also be matched to product specifications. Options include mild steel or powder coat finish and can be engineered to your project's specifications.

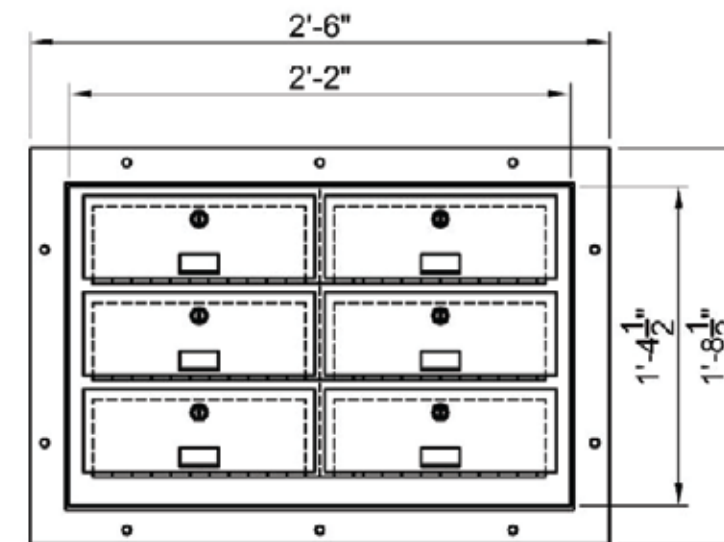

RIFLE LOCKER

SPECIFICATIONS&OPTIONS

Rifle Locker is fabricated from 10 gauge steel panels and 10 gauge steel plate frame. Standard units are available in 6, 12, and 24 compartments. Options include mild steel or powder coat finish and can be engineered to your project's specifications.

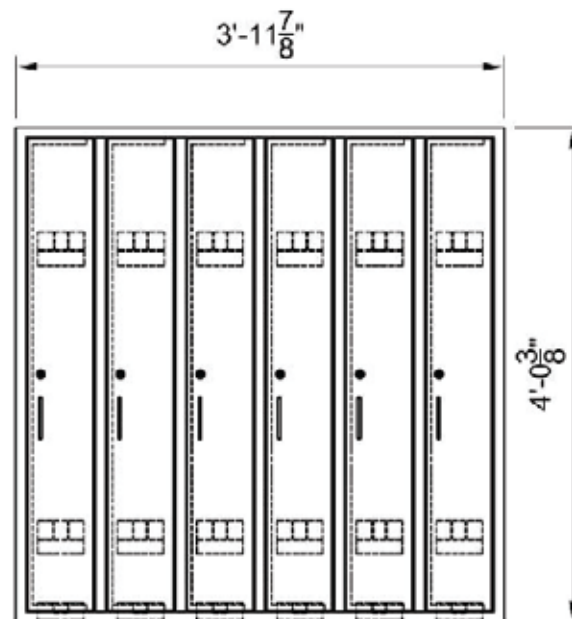

KEY CABINET

SPECIFICATIONS&OPTIONS

Our Key Cabinets are constructed with 10 gauge steel and can accommodate a wide variety of key configurations. 14 gauge key racks are utilized along with hinged interior panels to fit your exact requirements. We primer finish all mild steel (#4 finish stainless steel top optional). A warrantee can also be matched to product specifications. Options include powder coat finish, engineered to your project's specifications. The continuous mounting angle provided is shipped loose to accommodate surface or flush mounting applications.

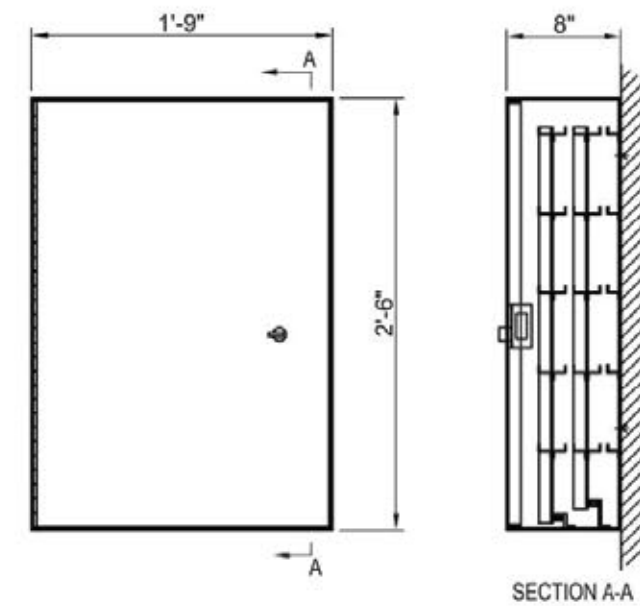

SHELF WITH SAFETY HOOKS

SPECIFICATIONS&OPTIONS

This item is constructed of 12 gauge steel and is neatly with edges ground to a smooth finish. We primer finish all mild steel (#4 finish stainless steel top optional). And a warrantee can also be matched to product specifications. Options include powder coat finish, engineered to your project's specifications. Ball and pin style or flat bar collapsible hooks are available in configurations of 2 or 4 hook setups.

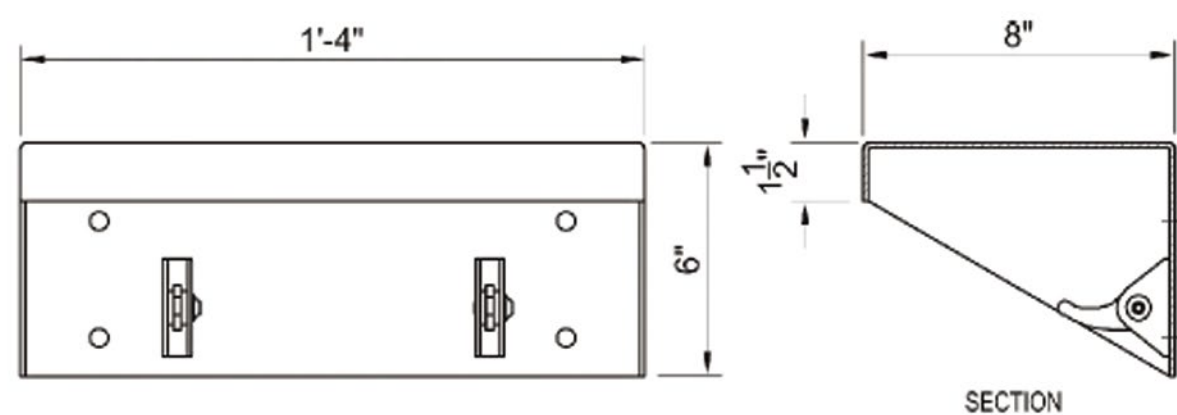

BALL TYPE SAFETY HOOKS

SPECIFICATIONS&OPTIONS

Our Ball type safety hook is incased in a 14 gauge stainless steel housing. Features include brushed finish, and warrantee to match project specifications. This item incorporates 4 holes for mounting to embed, or straight to the wall using security screws.

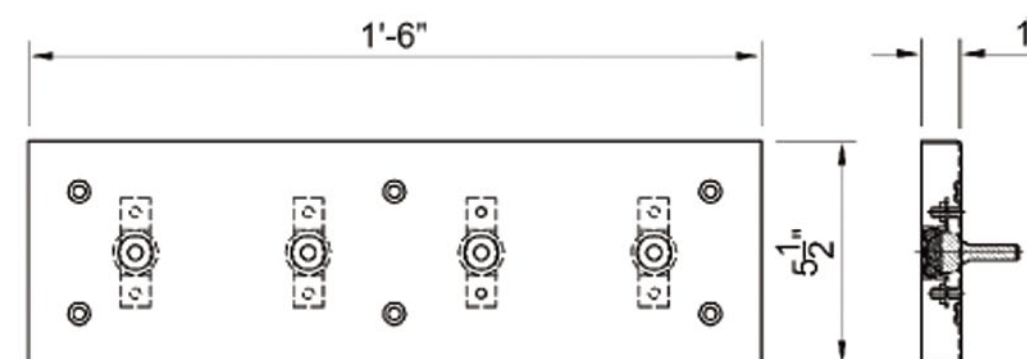

MIRROR

SPECIFICATIONS&OPTIONS

Our one piece mirror is a 18 gauge stainless steel, polished to a #8 finish. Small mirror is 11" x10 1/4" with eight counter-sunk mounting holes for 1/4" fasteners, back is plate is required for mounting. Stainless steel security screws included embed is option and we can warrantee to match project specifications.

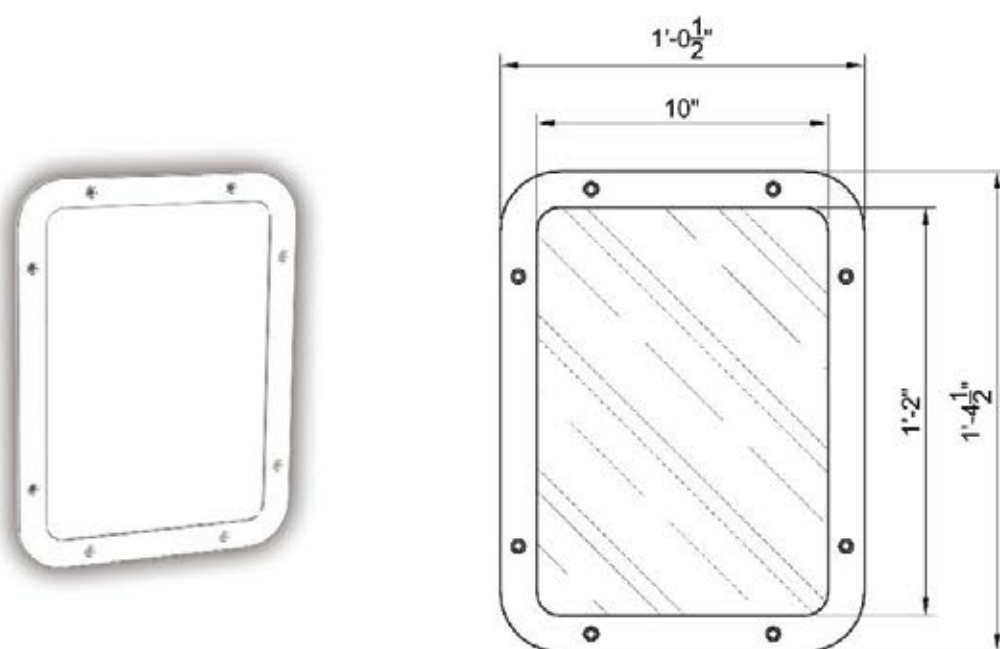

TOILET PAPER HOLDER

SPECIFICATIONS&OPTIONS

TP Holder are fabricated from all type 304 stainless steel and polished to #4 finish. Holder body are 14 gauge steel and mounted face plate are 7 gauge steel.

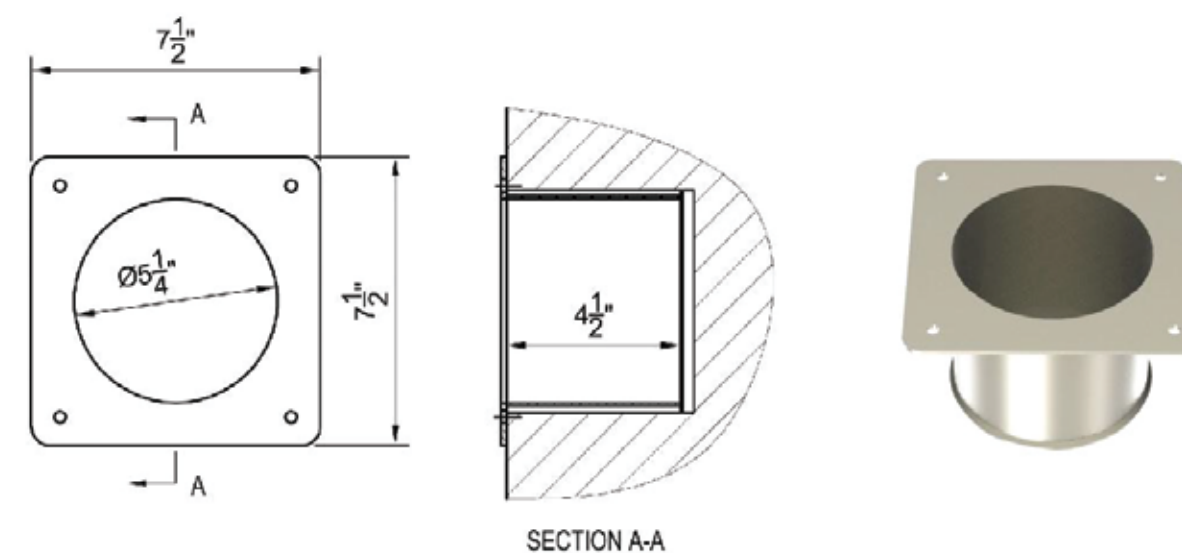

WIRE MESH DOOR

SPECIFICATIONS&OPTIONS

Steel Doors can be used for applications where maximum protection and safety is needed. Food pass and locking system options are provided, as well as heavy duty hinges, as per specifications

Steel door with 12 gauge steel frames And 1/4" Woven steel rods welded to the mainframe

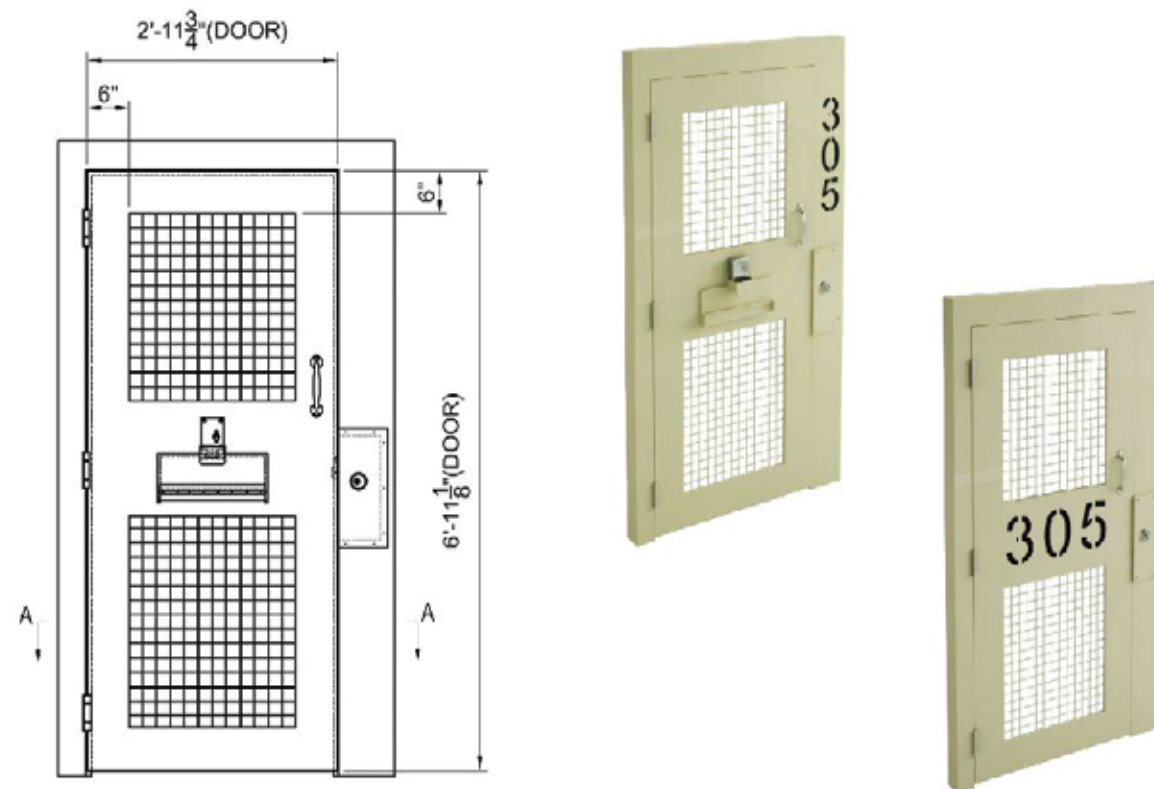

WIRE MESH PARTITION

SPECIFICATIONS&OPTIONS

Frame: Tubular shaped frame to be built up of a 12 ga. steel channel, 1 3/4\"

Mesh: 1/4\"

Mounting: Mount frame into a 10 ga. formed steel channel, expansion anchored to the wall, & field welded to the mount channel.

Finish: primer or powder coating finish.

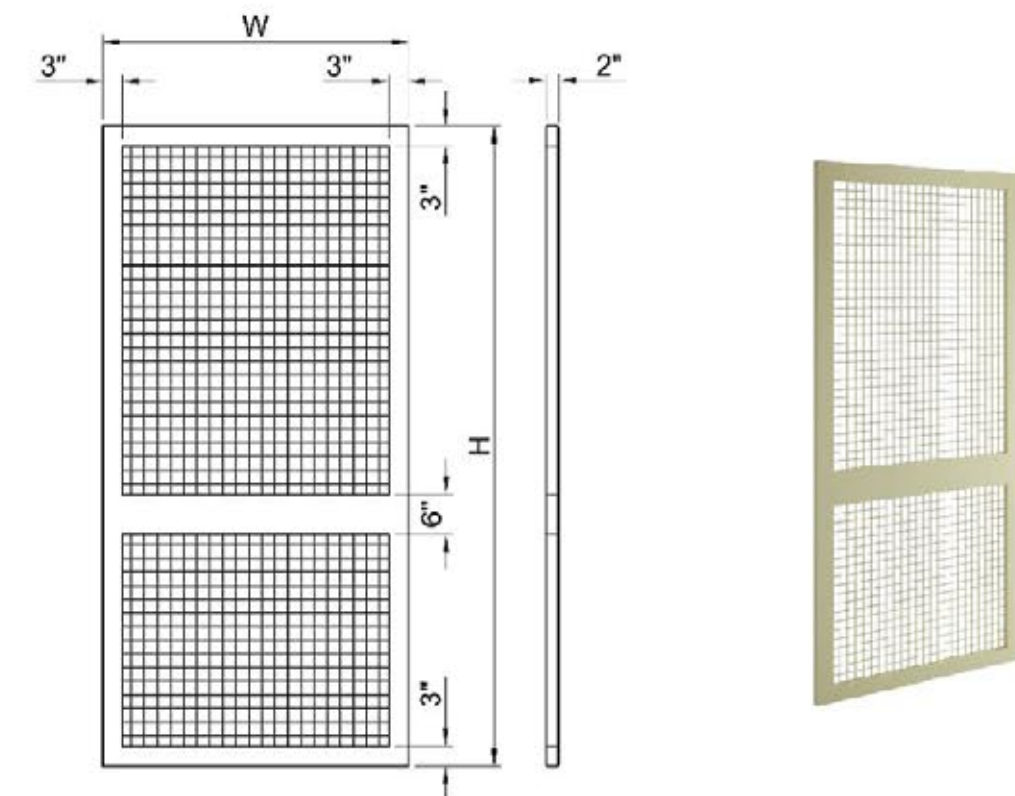

CONTACT US

“ DELIVERING
INSPIRATION
NOT JUST A
PRODUCT ”



USA

Contact : +1 (816) 888 1089
Email : info@build-wells.com
St. Louis, MO, USA

UAE

Telephone : +971 4 564 9817
Email : info@build-wells.com
A404 Prime Business Center
Head Office : Dubai,

EGYPT

Telephone : +971 4 564 9817
Email : info@build-wells.com
Salah Salem Road
1 El Obour Towers, 38
Cairo

TANZANIA

Telephone : +971 4 564 9817
Email : info@build-wells.com
Dar Es Salaam, 370 Oyster
Pearl Galleria, Peninsula

HOLLAND

Telephone : +971 4 564 9817
Email : info@build-wells.com
Rotterdam, 3011 TA
Blaak 520

UGANDA

Telephone : +971 4 564 9817
Email : info@build-wells.com